



P.O. Box 22326
Lincoln, NE 68542

PF: 402/421-9464 | WEBSITE: www.sitescapesonline.com
FX: 402/421-9479 | E-MAIL: info@sitescapesonline.com

INCH TOLERANCES U.O.S.

THE INFORMATION CONTAINED IN THIS DRAWING IS THE SOLE PROPERTY OF SITESCAPES, INC. ANY REPRODUCTION IN PART OR AS A WHOLE WITHOUT THE WRITTEN PERMISSION OF SITESCAPES, INC. IS PROHIBITED.

TITLE *AVONDALE
CHAIR*

PRODUCT NO.
AV5-1111

FRACTION-- $\pm 1/16"$
ANG----- $\pm 1^\circ$

*Available in powder coat and DuraCoat finishes

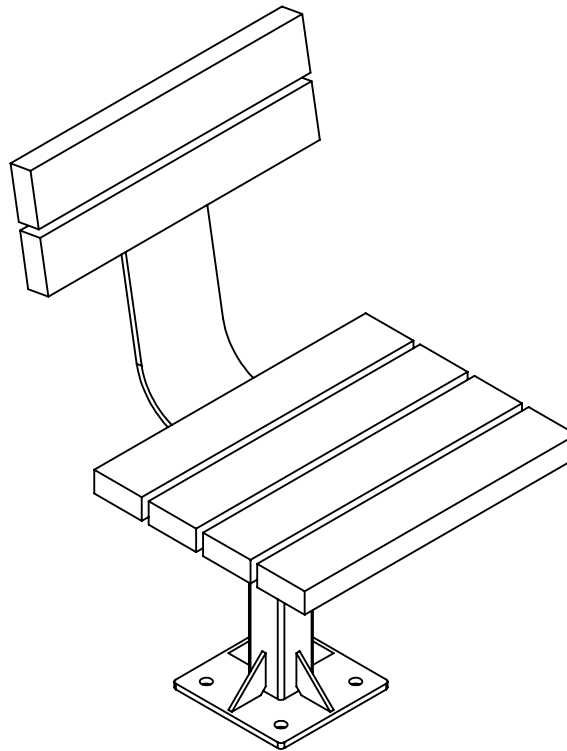



P.O. Box 22326
Lincoln, NE 68542

PF: 402/421-9464 | WEBSITE: www.sitescapesonline.com
FX: 402/421-9479 | E-MAIL: info@sitescapesonline.com

INCH TOLERANCES U.O.S.

FRACTION-- $\pm 1/16"$
ANG----- $\pm 1^\circ$

THE INFORMATION CONTAINED IN THIS DRAWING IS THE SOLE PROPERTY OF SITESCAPES, INC. ANY REPRODUCTION IN PART OR AS A WHOLE WITHOUT THE WRITTEN PERMISSION OF SITESCAPES, INC. IS PROHIBITED.

TITLE *AVONDALE
CHAIR*

PRODUCT NO.
AV5-1111

*Available in powder coat and DuraCoat finishes

MATERIALS LIST:

- (1) Seat Slats - 2" x 4" Nominal Ipe Slats
- (2) Support Tube - 2 1/2" Sq. x 11 Gauge Steel Tubing
- (3) Support Plate - 3/8" Steel Plate
- (4) Base Plate - 8" Sq. x 3/8" Stainless Steel Plate
- (5) Mounted with Four $\varnothing 1/2"$ x 4-5" Stainless Steel Anchor Bolts (Customer Supplied)

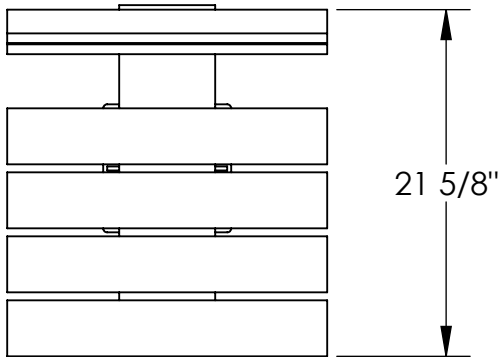

TOP VIEW

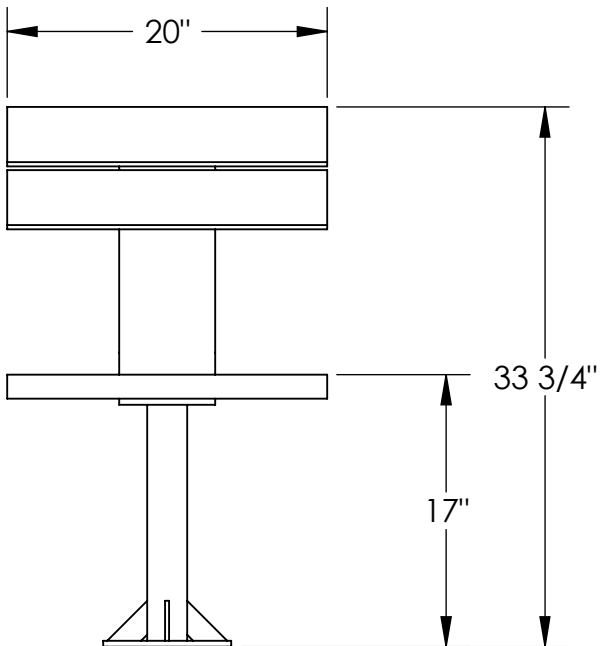

FRONT VIEW

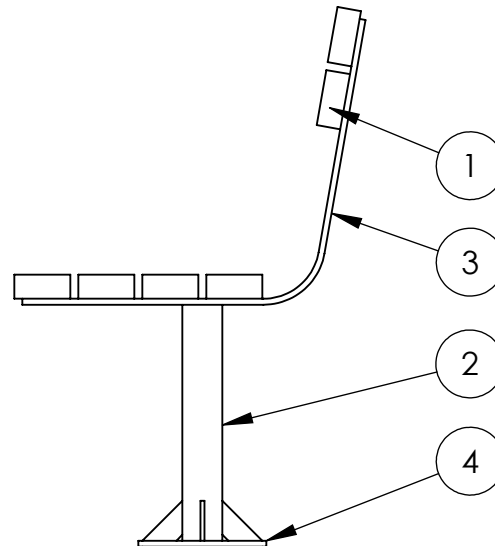

RIGHT SIDE VIEW

